

Overview

ARCHER RGB 10000 is a high-performance, low-cost full color laser projector, its light weight & high cost-performance ratio make it a perfect solution for large indoor venue or small outdoor shows.

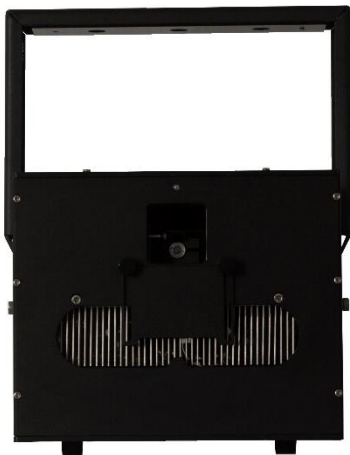

Front Panel



Rear Panel



Front 45°



Rear 45°

Specifications

Light source

Red :	3300 mw@638nm
Green :	2700 mW@520nm
Blue :	4000 mW@450nm

Beam Profile

Beam Diameter (Projector Window) :	5mm
Divergence (Full angle) :	< 1.2mrad
Modulation :	Analog 50KHZ
Laser Class :	Class IV

Scanner

Galvo :	40kpps @ 8° ILDA test pattern
Scan Angle :	60° Max

Interfaces & Controls

Control :	ILDA in (Differential), ILDA out
Safety :	Key Switch, FDA Scan-safe Switch
Remote Interlock :	5 pins XLR
Scan Image Invert :	Invert-X, Invert-Y, Rotate 90°
Color adjustment :	Intensity R, G, B (0-100%)
Mains :	Neutrik PowerCon®

Optional Components

Embedded Controller :	Pangolin FB4 (upon request)
-----------------------	-----------------------------

Thermal Control

Cooling : Active Cooling/heating by TEC Peltier Elements
Ventilation : 40mm Low noise thermal-controlled fan * 4

Electric

Operating Voltage : AC 110V-240V
Power Consumption : 350W Max

Physical

L* W * H : 376mm* 246mm* 190mm (Without Yoke)
Weight : 15kg (Without Yoke)
Housing Materials : Black Anodized Aluminum
IP grade : IP52
Packaging : Flight case

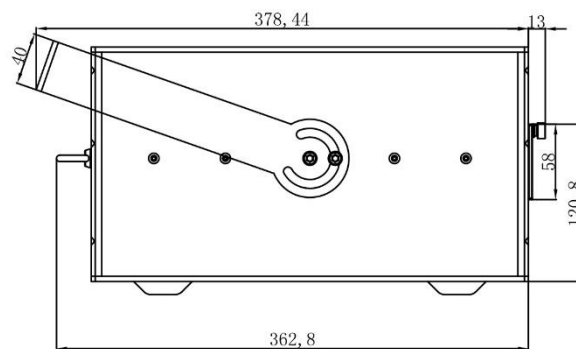
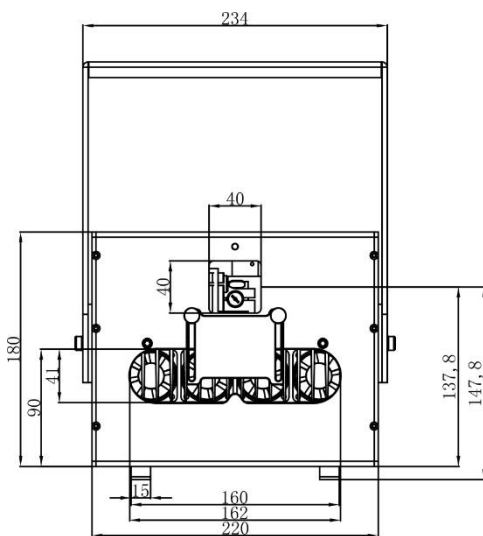

LIGHTING CRAFT

〒550-0027大阪市西区九条1-6-11-A号

TEL/FAX 06-6586-5859

lc@m3-craft.com